

MERIROAD

RC-4220 ST

For crushing roads



MERIROAD



# MERIROAD

## RC-4220 ST

# For crushing roads

### MERIROAD WORKING ENVIRONMENTS

#### ROAD CONSTRUCTION

- Gravel road maintenance
- Preparing of hauling lines
- Maintenance of forest roads
- Ice and hard packed snow removal from roads, side walks, intersections, parking areas

### EQUIPMENT

#### FEATURES

- Hardox liner (frame)
- STD Rotor with carbide cutters
- Possibility to turn the rotor

#### OPTIONS

- POC - safety clutch (patented)
- Support wheels
- Rear belt
- Hydraulic Top Link
- Rear support skids
- Front plate (UP-Rotation)

### Base machine demand

Four wheel tractor	
Mounting	CAT 2
Auxiliary hydraulic	1 pcs. 2-way
PTO	(540)/1000 rpm
Working speed	Creeper gear recommended

### Technical data:

Power range	70 - 90 hp	
Transmission	Mechanical PTO	
Final gear	Chain gear 2-row	
Clutch	POC-2 or FT44	
Rotor diam / width	400 / 2250mm	16 / 89 inch
Cutter qty.	96 (T25 Rotor)	
Working depth	200 mm / 8 inch	

### Main dimensions:

Lenght	1550 mm	61 inch
Widht	2700 mm	106 inch
Height	1220 mm	48 inch
Weigth	930 kg	1570 lbs
Weigth, with options	1290 kg	2320 lbs



SUOKONE OY  
88610 Vuokatti  
FINLAND

tel. +358 8 666 2011  
suokone@suokone.com  
www.mericrusher.com

## TECHNICAL FEATURES

## MERIROAD RC-4220 ST

### FRAME

- Frame is having light and strong structure.

#### **HARDOX WEAR PLATE**

- HDX-Wear plate is attached by welding and it can be replaced afterwards

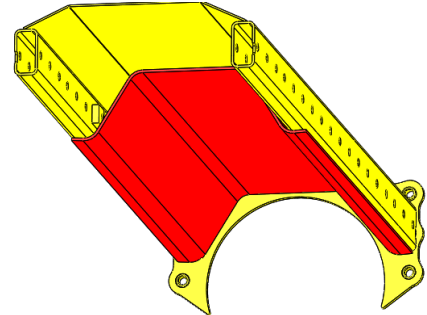

### ROTOR

- **STD** rotor guarantee very fine crushing result, and smooth behavior while crushing.

#### **TERÄ 84000 nut locking**

- Carbide is cylinder shape and goes in to the body

#### **TERÄ 84006X nut locking**

- Carbide is mushroom shape, and it goes deep in to the body. Larger diameter carbide is better against the wear.

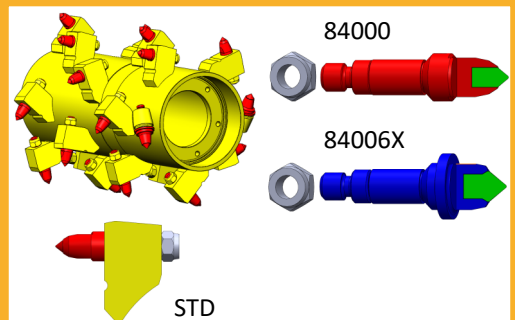

### TRANSMISSION

- Transmission consists of T-gearbox, secondary cardan shaft, safety clutch and final chain gearbox
- Final chain gearbox is having oil lubrication and sprocket/chain gear.
- ST- has one final chain gearbox

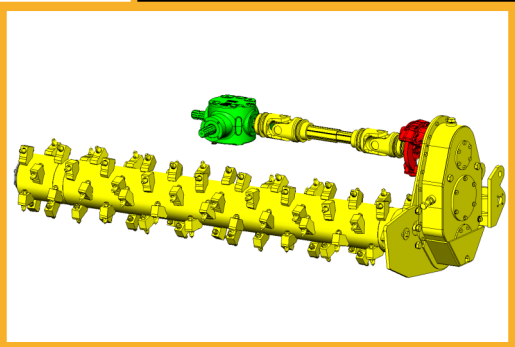

### SAFETY CLUTCH

- Clutch is designed to protect the transmission. Clutch is cutting of the peak loads through the transmission line, both crusher and tractor's.

- Clutch options:

#### **POC** pressure operated clutch with brake pads

Clutch can be adjusted to match with tractor's power

#### **FT** friction clutch with friction plates

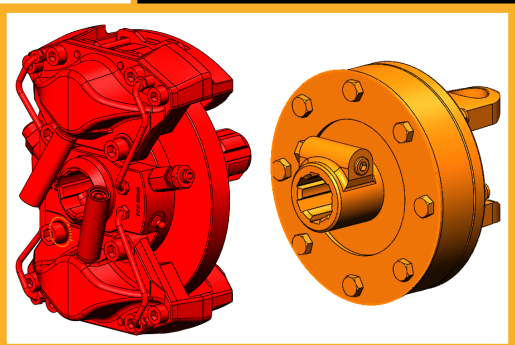
**SUOKONE**

## OPTIONS

### UP-ROTATION and DOWN-ROTATION

MERIROAD  
RC-4220 ST

#### SUPPORT WHEELS, front mounted

- Support wheels are used for adjusting and controlling working depth together with hydraulic tilt cylinder
- In soft conditions wheels are used to support the crusher

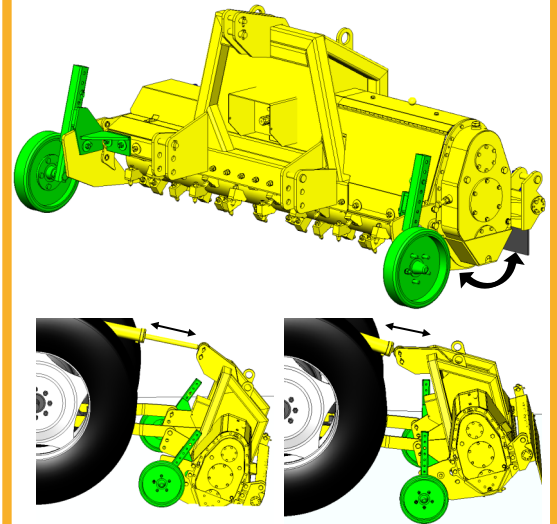

#### REAR BELT

- In DOWN-ROTATION rear plate prevents stones and other objects being thrown uncontrolled (**necessary equipment**)

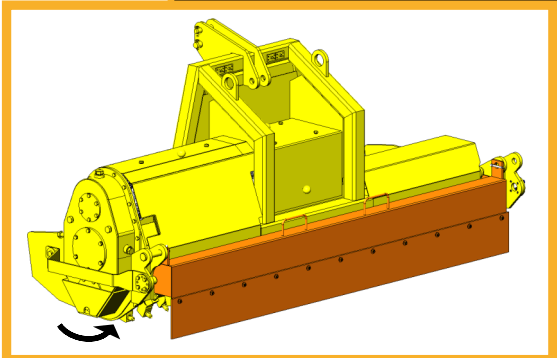

#### REAR SUPPORT SKIDS

- Rear support skids are used for adjusting and controlling the working depth. Rear support skids follow the smooth crushed surface making the crushing depth adjustment easy and sharp.
- Skids can be equipped with hydraulic cylinders for crushing depth control or they can be fixed and the depth is controlled with a hydraulic tilt cylinder
- Skids can not be assembled simultaneously with support wheels.
- Rear skids includes rear belt

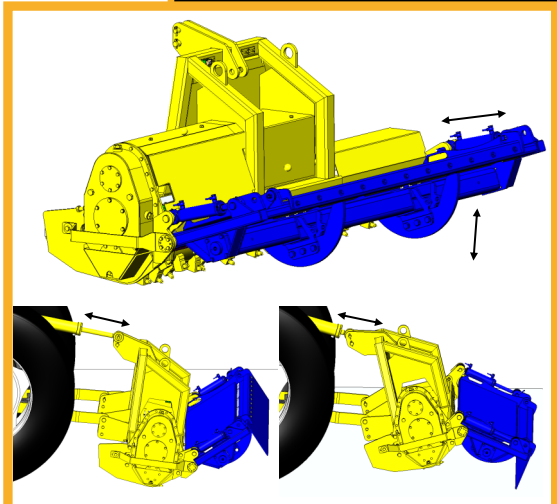

SUOKONE

## OPTIONS

### UP-ROTATION

MERIRoad

RC-4220 ST

#### UP-ROTATION

- In UP-ROTATION cutters go up on the tractor side of the crusher
- Rotor's rotating direction effects to the method of working

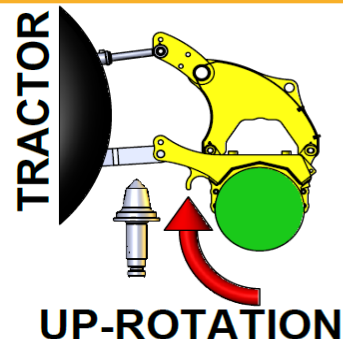

#### FRONT PLATE

- In UP-ROTATION front plate prevents stones and other objects being thrown on the tractor. (**necessary equipment**)
- Plate can be used to control material flow to the rotor

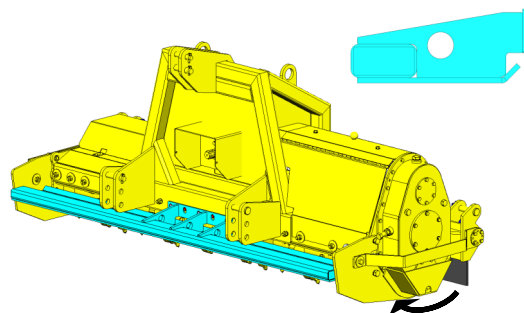

Two Harbors, MN 218 606 2010  
[www.CrushingMechanics.com](http://www.CrushingMechanics.com)  
[sales@CrushingMechanics.com](mailto:sales@CrushingMechanics.com)



SUOKONE